

# Newark & Sherwood District Council

## Street Naming and Numbering

Developer: Meliorland Ltd

Development Name: Former Sir John Arderne Public House, 10 Market Place, Newark

Ref. No. 26/00001/CONVER

Planning Application No. 25/00755/FUL



### Postal Address Allocations

Plot No	Postal Address	UPRN
<b>Street Name: Market Place</b>		
Unit 1, Former Sir John Arderne Public House, 10	Flat 1 Arderne House 10 Market Place Newark NG24 1DU	010097474758
Unit 2, Former Sir John Arderne Public House, 10	Flat 2 Arderne House 10 Market Place Newark NG24 1DU	010097474759
Unit 3, Former Sir John Arderne Public House, 10	Flat 3 Arderne House 10 Market Place Newark NG24 1DU	010097474760
Unit 4, Former Sir John Arderne Public House, 10	Flat 4 Arderne House 10 Market Place Newark NG24 1DU	010097474761
Unit 5, Former Sir John Arderne Public House, 10	Flat 6 Arderne House 10 Market Place Newark NG24 1DU	010097474762
Unit 6, Former Sir John Arderne Public House, 10	Flat 5 Arderne House 10 Market Place Newark NG24 1DU	010097474763
Unit 7, Former Sir John Arderne Public House, 10	Flat 7 Arderne House 10 Market Place Newark NG24 1DU	010097474764
Unit 8, Former Sir John Arderne Public House, 10	Flat 8 Arderne House 10 Market Place Newark NG24 1DU	010097474765
Ground Floor Retail, 10 Former Sir John Arderne Public House	Commercial Unit Arderne House 10 Market Place Newark NG24 1DU	010097474766

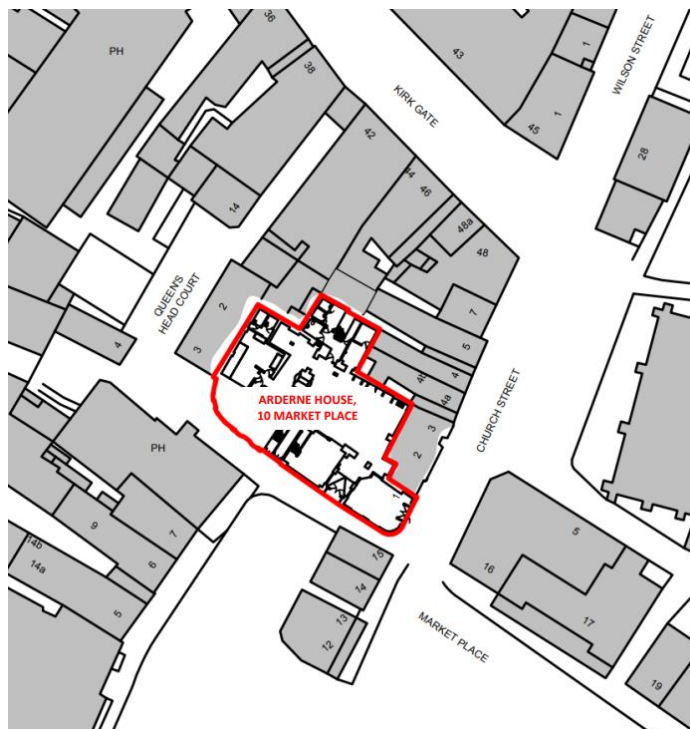

Crown Copyright and database rights 2025 Ordnance Survey 100018606

**Official copy issued on 2nd January 2026 under the Council's Statutory Street Naming and Numbering powers.**

The plan shows the general position, not the exact position of an address. It may be subject to distortions in scale.

The Unique Property Reference Number (UPRN) is generated from the NLPG, in accordance with BS7666.

Postcodes are allocated by Royal Mail under the Postal Services Act 2000

# Newark & Sherwood District Council

## Street Naming and Numbering



Developer: **Meliorland Ltd**

Development Name: **Former Sir John Arderne Public House, 10 Market Place, Newark**

Ref. No. **26/00001/CONVER**

Planning Application No. **25/00755/FUL**

### Postal Address Allocations

#### GROUND FLOOR PLAN

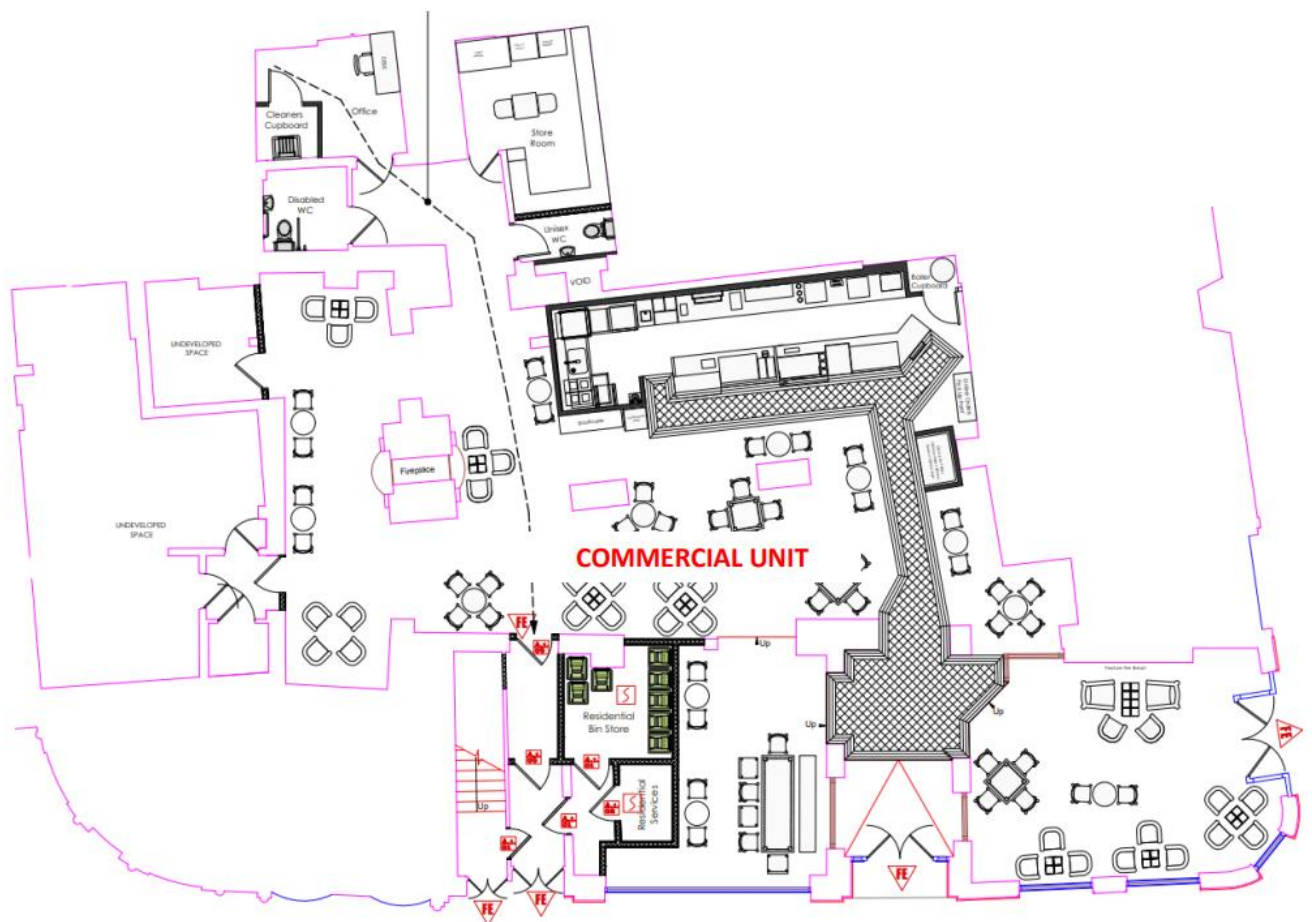

# Newark & Sherwood District Council

## Street Naming and Numbering



Developer: Meliorland Ltd

Development Name: Former Sir John Arderne Public House, 10 Market Place, Newark

Ref. No. 26/00001/CONVER

Planning Application No. 25/00755/FUL

### Postal Address Allocations

#### FIRST FLOOR PLAN



# Newark & Sherwood District Council

## Street Naming and Numbering



Developer: Meliorland Ltd

Development Name: Former Sir John Arderne Public House, 10 Market Place, Newark

Ref. No. 26/00001/CONVER

Planning Application No. 25/00755/FUL

### Postal Address Allocations

#### SECOND FLOOR PLAN

